



**LA101**



**LA201**



**LA301**

**FP101**

Follower Plate (5 gallons)

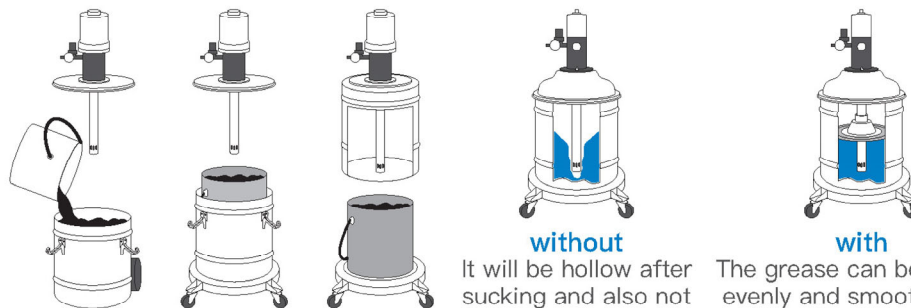

**without**

It will be hollow after sucking and also not easy to suck.

**with**

The grease can be sucked evenly and smoothly with follower plate.

**Air Operated Fluid Pump / Grease Pump Feature**

- (1) Pump moves and oil suction are two separation system, it won't contaminating grease.
- (2) Typically used in workshops, service stations, fleet maintenance, mining, agriculture, armed forces, construction, trains, etc.
- (3) The pump is made of aluminum alloy by forging.
- (4) The inner diameter of the barrel is 350mm, which can accommodate 5-gallon containers of original grease from various countries.

**Usage**

- (1) General 00#-3# grease all can be infused into smoothly.
- (2) Included FP101 follower plate, can be used with higher viscosity grease or cold areas.

Model	Capacity	Air Input Pressure	Pressure Ratio	Grease Output Pressure	Deliver Rate	Hose Length	N.W.	G.W.	CUFT
LA101							18.5 kgs	21.0 kgs	5.3'
LA201	20L	4~9 bar 60~130 psi	45 : 1	180~405 bar 2700~5850 psi	9 g/cycle	10 ft	19.8 kgs	22.8 kgs	6.2'
LA301							16.6 kgs	21.1 kgs	